

# CELLULAR MODEM

## RELIABLE SOLAR PANEL DATA

### MLSH-COM-2



- COMPATIBLE WITH THE MYLIGHT SYSTEMS RANGE AND ALL INVERTERS
- GUARANTEED TRANSMISSION OF ENERGY DATA
- PLUG&PLAY FOR 99% OF SYSTEMS



#### GUARANTEED **INTERNET CONNECTION**

- Compatible with multiple operators, so you can select the best network
- 2G/3G coverage of **the whole of Europe**
- Internet subscription included



#### **RELIABLE DATA**

- Special connection for the solar panel system
- Signal quality display by LED and in the MyProPortal software
- Warnings when the subscription is exceeded



#### **A MODEM DESIGNED FOR **CONNECTED OBJECTS****

- Plug&Play : immediate connection, no settings required
- Standard connections through Ethernet ports
- Numerous accessories available

## COMPATIBILITY OF THE CELLULAR MODEM



Energy management solution  
Connected and MG3 unit



MySmartBattery



PLC plug

Product overview

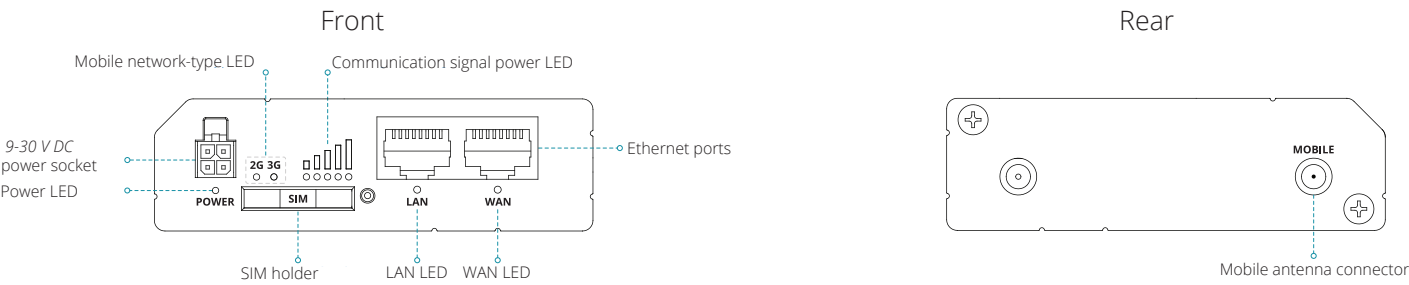

Available accessories

Power supply options

- 1 Supply by plug and socket (MLSH-COM-11)  
*Included in the kit*
- 2 Supply on DIN rail (MLSH-COM-13)  
*On request*

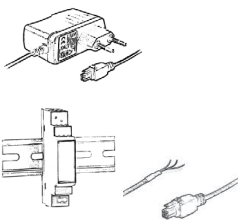

Installation options

- 1 DIN rail (MLSH-COM-8))  
*Included in the kit*
- 2 Wall-mounted or on table

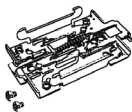

Mobile antenna options

- 1 Screw-in rod (MLSH-COM-6)  
*On request*
- 2 Self-adhesive flat antenna (MLSH-COM-7)  
*Included in the kit*

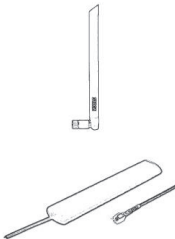

INSTALLATION DIAGRAM

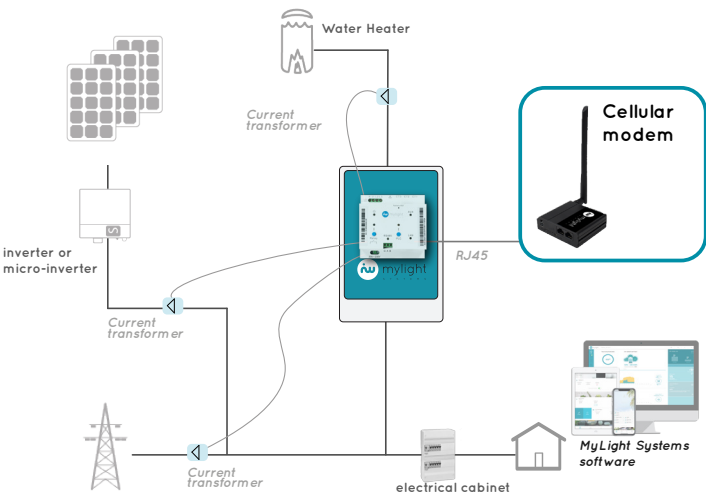

DIMENSIONS AND CONTENTS

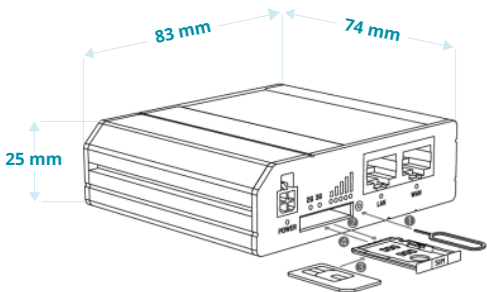

The MLSH-COM-2 kit contains:

- Cellular modem
- SIM card
- Plug and socket power supply
- DIN rail
- Self-adhesive flat antenna

